



The TT9500 kit you received should include the following components:

Accessory	Picture	Description
TT9500		The TT9500 GPS tracking device (With Built-In Relay)
Power Harness		The Power Harness to provide power to the TT9500 device

## TT9500 Installation Steps

### 1. Finding a Suitable Location to Mount the Device:

The device should be mounted underneath the dash and not be visible. There should not be any metal obstructing the device's view of the sky. The device is equipped with an internal antenna, and should be placed with the label pointing UP, as shown in Figure 1.



Figure 1 Placement of TT9500 Device

### 2. Checking the Device:

The device has three light indicators on the front, as shown in Figure 2.



Figure 2 GSM, GPS & Power Light Indicators

Below is a table showing the status of these lights, and what they indicate. Make sure that the three lights are ON and solid before finishing installation.

\*\*To acquire a GPS Signal the vehicle will need to be outdoors, away from cover for several minutes.

Color	Function	Behavior
RED	Power	ON = Unit Powered
BLUE	GPS Indicator	ON = GPS OK OFF = No GPS
GREEN	Network	ON = Cell Signal OK Blinking = Searching

### 3. Basic Installation:

a. Connect the wires from the Power Harness to the vehicle as follows, (Refer to Figure 3):

**RED – TO Constant Power**

**BLACK – TO a Ground Source**

**WHITE – REFER TO NOTE (Ignition)**

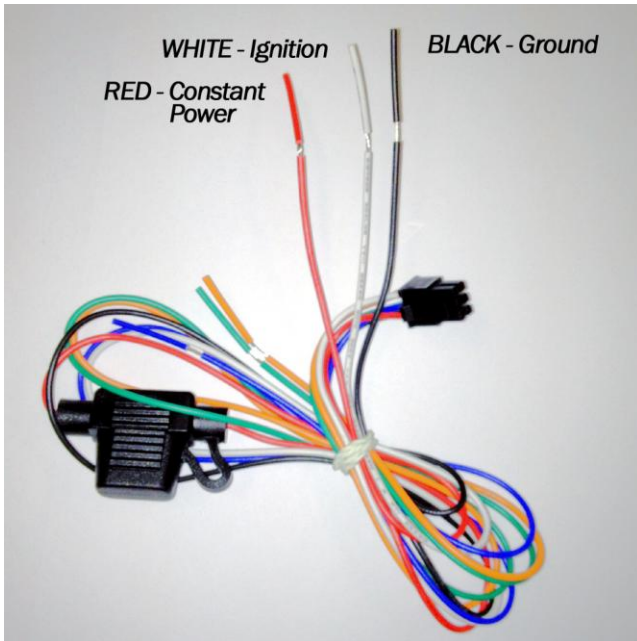

Figure 3 shows the exposed wires.

b. Once the wires are connected, plug the Power Harness into the back of the device, as shown in Figure 4.

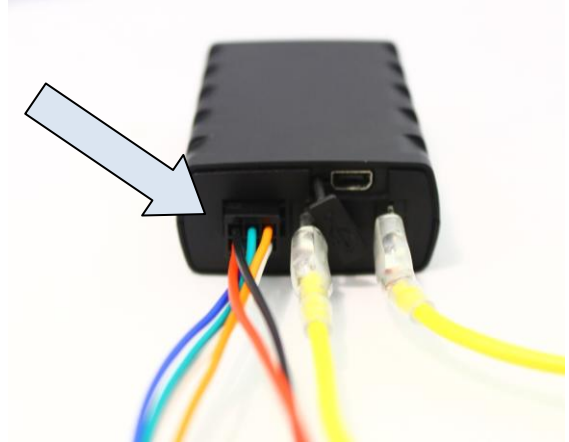

Figure 4 Harness Connected to TT9500+

**NOTE:** If the device is equipped with an optional Late Payment Reminder function, the Ignition Wire (**WHITE** wire) is required to be connected to a constant source of ignition during installation. If this option is not included, wiring the **WHITE** wire to an ignition source is not necessary.

### 4. Starter Interrupt and Relay Connections (Optional):

For this operation the objective is to interrupt the starter so the next time the ignition is engaged, the engine will not start. You will need to cut the starter cable on the vehicle before taking the following steps.

- Slide a plastic cover down both ends of the starter cable and crimp the ends of the cables using the provided crimp connectors.
- Attach crimp connectors to relay pins located on the back of the TT9500 device.
- Slide the plastic cover over the relay pins.

Refer to figure 5 for full relay assembly.

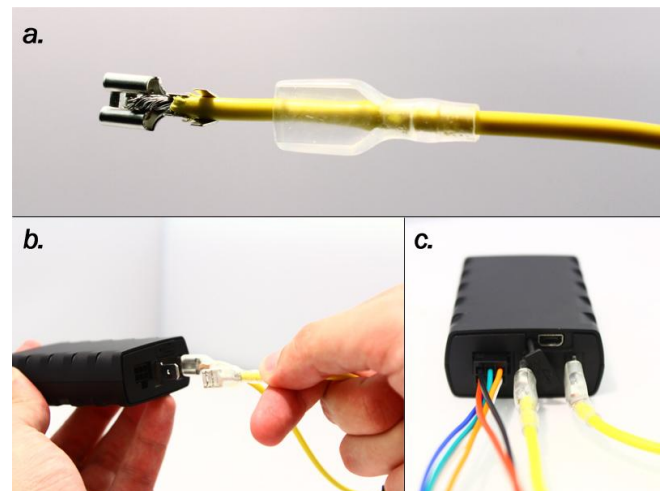

Figure 5 Relay assembly