

# OWNERS MANUAL



BOW WOOD CANADA 1.888.BOW.WOOD(269.9663)  
Fax: 306-483-2102 email: [design@bowwood.net](mailto:design@bowwood.net)

## CONTENTS

### CARE & MAINTENANCE

Corian® Countertops.....	3
Laminate Countertops and Fronts.....	3
Cabinet Interiors.....	3

### EQUIPMENT

Foot and Knee Activated Faucets.....	4
Dual Memory Timer/Clock.....	5

### ADJUSTMENTS

Hinges & Shelf Pins.....	8
Drawer Touch Latch & Cabinet Levelers.....	9

### CORD MANAGEMENT

Rear Support, Centre Island & Sterilization Centre Cord Management.....	10
---	----

### ASSEMBLY / DISASSEMBLY

Rear Support Disassembly.....	11
Centre Island Assembly.....	12
RS PEX Assembly.....	13
Sterilization Centre Assembly.....	14

### INSTALLATION

Steel Base Installation.....	15
Pass through X-ray Installation.....	16

### TWO YEAR WARRANTY

**Guaranteed to be free from defects in workmanship and materials for two years from the date of purchase. Warranty covers the replacement of defective parts or component only (labour not included). Warranty does not cover damage by misuse, improper installation or accident. Warranty does not cover damage or discoloration caused by cleaning or disinfecting processes and chemicals. Freight damage is the responsibility of the freight carrier.**

## **CARE AND MAINTENANCE**

### **CORIAN® COUNTERTOPS:**

- Routine daily cleaning can simply be done with soapy water or ammonia-based cleaners. These will remove most dirt and stains from all types of Corian finishes.
- Do not use alcohol based surface disinfectants.
- Avoid exposing Corian® to strong chemicals. If contact occurs, quickly flush the surface with water.
- Although Corian® is quite resistant to heat, always use a hot pad or other insulating device to reduce risk of damage.
- Minor damage such as, nicks, scratches, stains or burns can be repaired with a light abrasive cleaner and a product such as a Scotch-Brite® pad (very fine).
- If damage is more significant, please contact Bow Wood or the dealer from which you purchased your cabinets for further instruction.

### **LAMINATE COUNTERTOPS AND FRONTS:**

- In most cases laminate counters can be cleaned using a damp nonabrasive cotton cloth and a mild liquid detergent or household cleaner. Rinse with clean water, using a clean, nonabrasive cotton cloth. Do not flood the laminate, especially near seams, since water can penetrate and cause the core to swell. Dry with a soft, clean, nonabrasive cloth.
- Do not use abrasive cleaners or materials to clean surfaces.
- Knives or other sharp instruments can slice or scratch the laminate surface, so always use care when using these items.
- Ceramics and abrasive objects can cause scratching and premature wear, so avoid sliding these items across the surface.
- For difficult stains or if substantial damage occurs please contact Bow Wood, or the dealer from which you purchased your cabinets.

### **CABINET INTERIORS:**

- Once again in most cases cabinet interiors can be cleaned using a damp nonabrasive cotton cloth and a mild liquid detergent or household cleaner. Rinse with clean water, using a clean, nonabrasive cotton cloth. Do not flood material, especially near seams, since water will penetrate and may cause the melamine to swell. Dry with a soft, clean, nonabrasive cloth.
- Do not use abrasive cleaners or materials to clean surfaces.

## **EQUIPMENT**

### **FOOT AND KNEE ACTIVATED FAUCETS**

Dental cabinets with sinks can be equipped with an optional foot or knee activated faucet. If your cabinet has this option, please read the operating instructions below.

- To operate the “Tapmaster” faucet press the foot or knee lightly against the vertical face of the kick pedal and open the faucet to the desired flow and temperature. By releasing the pedal, the “Tapmaster” shuts off the water flow to the faucet. Once the faucet has been adjusted it may be left open. For continuous operation, press down in the middle of the top angled face until the pedal latches. This will provide continuous flow to the faucet until such time as the vertical face is tapped again to unlatch the pedal.
- A removable decal is provided which may be located on any hard smooth surface near the faucet to alert people to its method of operation.

## **DUAL-MEMORY TIMER/CLOCK**

### **FEATURES**

- Jumbo display 4 channel LCD count-down / count-up timer with clock and alarm features.
- 6 digit display shows hour, minute and second setting for timers and clock.
- Automatic count-up after timer counts down to zero.
- Count-Down Timer: Maximum setting is 99 hours , 59 minutes and 59 seconds. Counts down at 1 second resolution.
- Count-Up Timer: Maximum count-up range is 99 hours, 59 minutes and 59 seconds. Counts up at 1 second resolution.
- Memory recall function for count-down timers.
- Timer alarm sounds for 1 minute when timer counts down to zero.

### **CLOCK MODE**

- Press the CLOCK button to enter clock mode. Preset time (hours, minutes and seconds) and flashing colon are displayed.
- Press and hold START/STOP button for 3 seconds to toggle 12/24 hour format.

### **CLOCK SETTING MODE**

- Press and hold the CLOCK button for 3 seconds (until beep) to enter time setting mode. "HOUR", "MINUTE", "SECOND" and colon flash on display. The "P" indicator shows in 12 hour format.
- Press the HOUR button to advance hour setting. Press and hold for 2 seconds for fast setting.
- Press the MINUTE button to advance minute setting. Press and hold for 2 seconds for fast setting.
- Press the SECOND button to reset second digit to zero when the second digits are within 00-29 second range. Press S button to reset second digits to zero and minute digits advance by 1 increment when second digits are within 30-59 second range.
- When the time setting for the clock is ready. Press the clock button once to return to normal clock display mode.



## NOTE:

When the timer is running, the corresponding indicator (T1,T2,T3,T4) flashes on display. All four timers can run at the same time. When the timer reaches to 0:00 00, the buzzer will sound and the corresponding indicator (T1,T2,T3,T4) will flash relatively slower. More than one indicator can flash at the same time.

## COUNT-DOWN TIMER SETTING

- Press the T1, T2, T3, or T4 button to enter the desired timer channel. In timer mode, the colon does not flash and the corresponding timer indicator "T1", "T2", "T3" OR T4 shows on display.
- Press the HOUR button to advance hour digit.
- Press the MINUTE button to advance minute digit.
- Press the SECOND button to advance second digit.
- Press the HOUR, MINUTE, or SECOND button for 2 seconds for fast setting of the corresponding digit.
- Press the CLEAR button to clear the Count-Down Timer and the corresponding timer memory to 00H00M00S.
- Press the HOUR and CLEAR buttons simultaneously to clear the hour digit setting only.
- Press the MINUTE and CLEAR buttons simultaneously to clear the minute digit setting only.
- Press the SECOND and CLEAR buttons simultaneously to clear the second digit setting only.



## COUNT-DOWN TIMER START/STOP

- After time setting is ready, press the START/STOP button once. The timer will start to countdown at 1 second resolution.
- Press the START/STOP button once to stop the counting timer.
- Press the START/STOP button once again, the timer will resume counting.

## COUNT-DOWN TIMER ALARM

- When the timer counts down to 00:00 00 in its timer mode, the buzzer will sound.
- When the timer counts down to 0:00 00 but not in its timer mode, the buzzer will sound and the flashing frequency of corresponding indicator will flash relatively slower.
- When 2 timers count down to 00:00 00 at the same time, the timer which shows on display will sound and the other's indicator will flash relatively slower.
- Press any button to stop timer alarm and the count-up timer.

**COUNT-DOWN MEMORY RECALL**

- Press the START/STOP button to recall previous timer setting. Press the START/STOP button again to start the timer.

**STOP WATCH MODE**

- In timer mode, clear timer by pressing the CLEAR button.
- Press the START/STOP button to start the stop watch counting up at 1 second resolution.
- Press the START/STOP button to stop counting up.
- When the timer counts up to 99H 59M 59S it starts to count up again from 00H 00M 00S.

**BATTERY REPLACEMENT**

Use a coin to open the battery cover at back side of timer, following the arrow direction. Remove the exhausted battery, and insert a new 1.5V G-13 size button cell battery (make sure positive (+) is facing up.) and close battery cover.

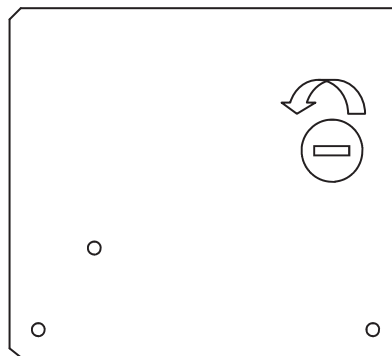

## ADJUSTMENTS

### TO ATTACH DOORS

align the pin in the hinge to the front slot in the hinge plate and snap the back of the hinge into place. You should hear a distinct "clip" sound signifying that the hinge is in place.

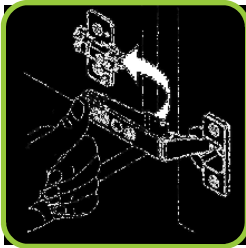

### TO REMOVE DOORS

simply pinch the clip at the back of the hinge and pull away from the cabinet.

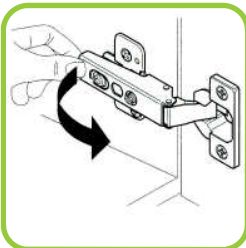

### FOR HEIGHT ADJUSTMENT

simply turn the height adjustment screw clockwise or counter clockwise to raise or lower the door to it's desired height.

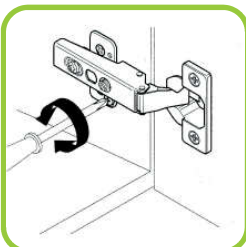

### FOR SIDE ADJUSTMENT

turn front adjustment screw clockwise or counterclockwise until you reach the desired location.

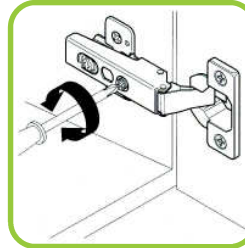

### FOR DEPTH ADJUSTMENT

turn the back adjustment screw clockwise or counterclockwise until you reach the desired location.

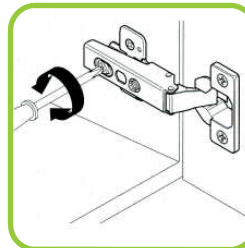

### SHELF PIN ADJUSTMENT

Simply pull the shelf pin out of its existing hole and relocate it to the new position. If the pin is difficult to remove, just use a pair of pliers or some other gripping device and twist it out. If the pin is resistant to go into the new hole, simply tap it in with a small hammer.

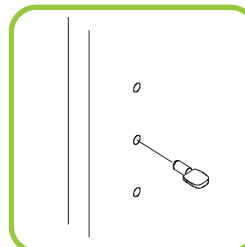



## ADJUSTMENTS

### DRAWER TOUCH LATCH

Bow Wood's drawer touch latch can be adjusted in one simple procedure. Remove the drawer and turn the barrel either clockwise, which will pull the drawer in, or counterclockwise, which will push the drawer out.

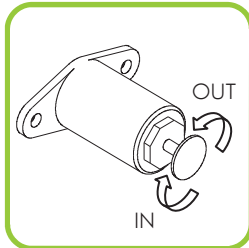

### EQUIPMENT GARAGE LEVELERS

Bow Wood's Cabinet Levelers can be adjusted in one simple step. Simply apply the proper sized wrench or a properly adjusted crescent wrench to the hex shape near the bottom of the leveler. Turn the desired levelers in either direction until your cabinet is level.

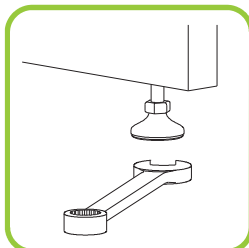

### STEEL BASE LEVELERS

Just like our garage levelers, simply apply the proper sized wrench to the hex shape near the bottom of the leveler, or a screwdriver to the top of the leveler. Turn the desired levelers in either direction until your cabinet is level. Levelers can be accessed through the opening in the bottom of the base cabinets.

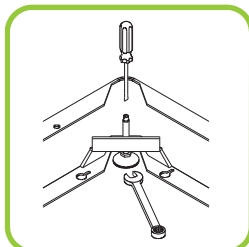

## CORD MANAGEMENT

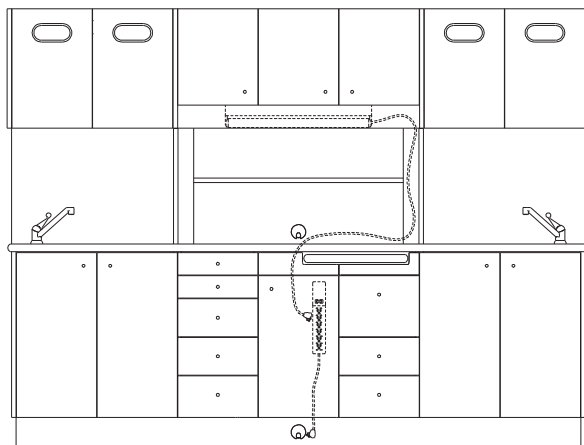

### REAR SUPPORT

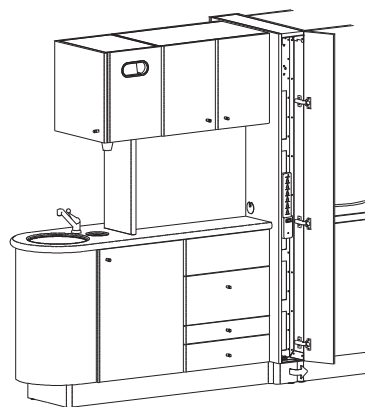
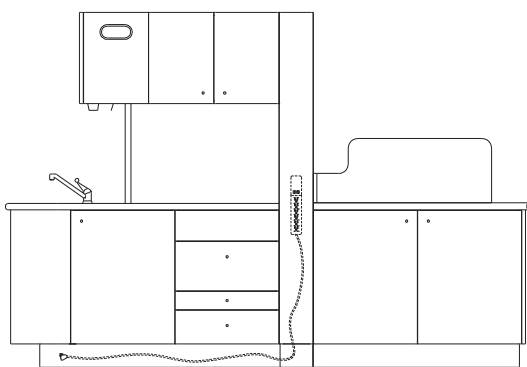

### CENTRE ISLAND

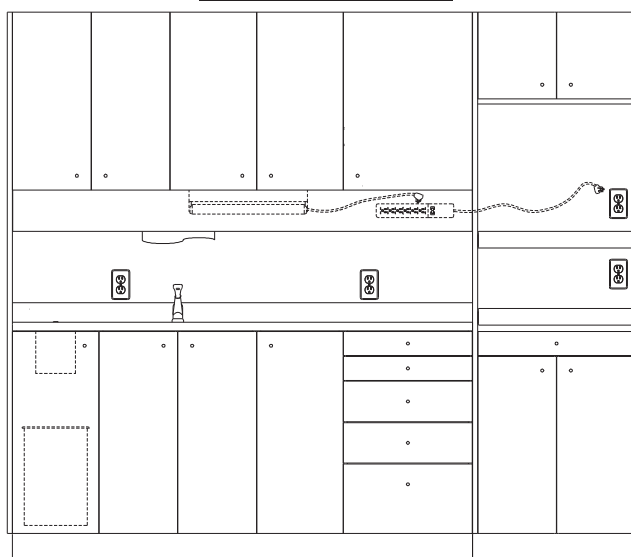

### STERILIZATION CENTRE

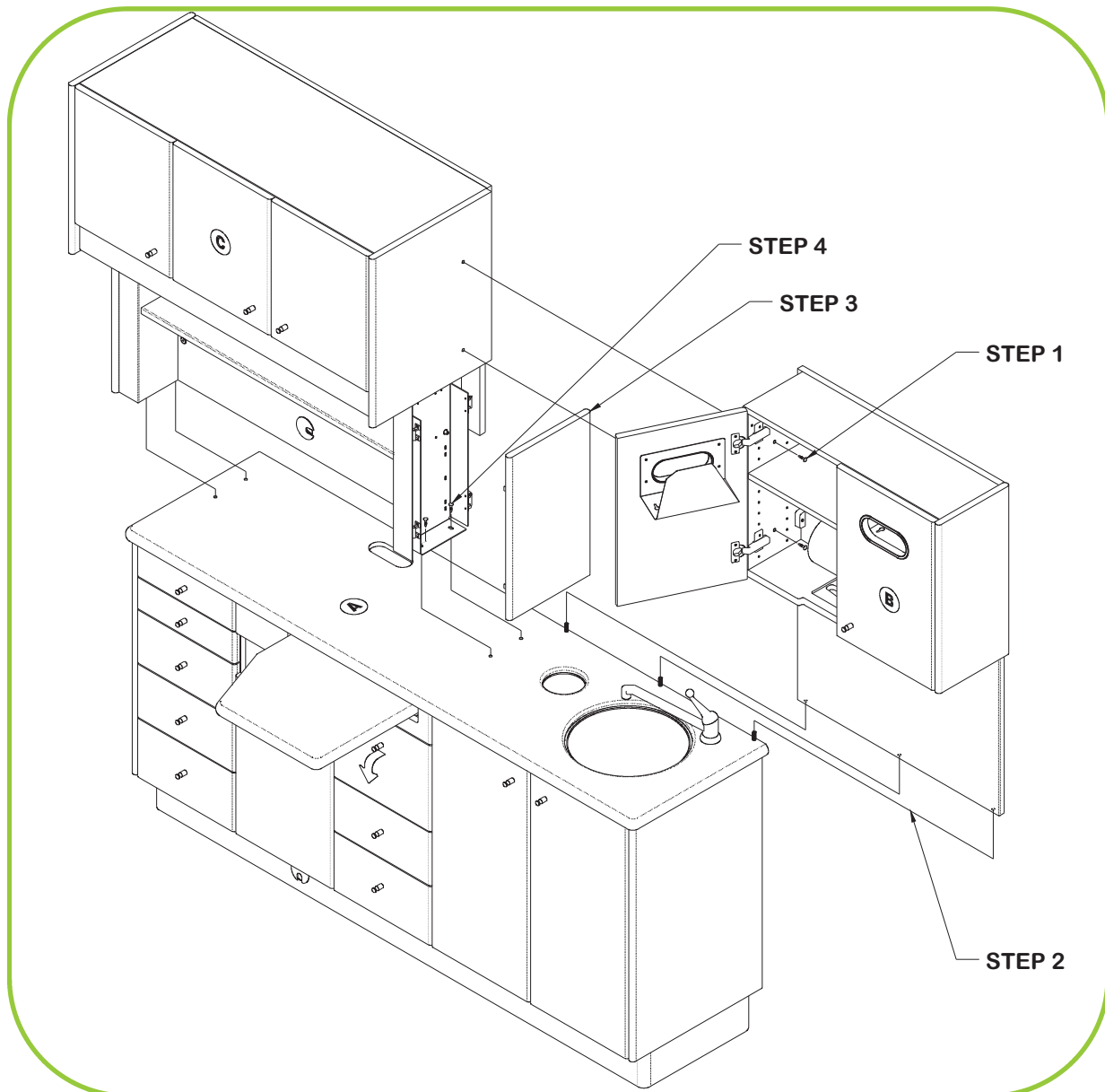
**ASSEMBLY / DISASSEMBLY****REAR SUPPORT**

**STEP 1:** Open the glove/cup/towel cabinet door and remove the 2 fastening screws.

**STEP 2:** Lift the glove/cup/towel assembly "B" off of the countertop "A"

**STEP 3:** Remove the column front on both sides by pulling outward to reveal the column fasteners.

**STEP 4:** Remove the 2 fastening screws at each column and lift the upper assembly "C" from the countertop "A"

## ASSEMBLY / DISASSEMBLY

### CENTRE ISLAND

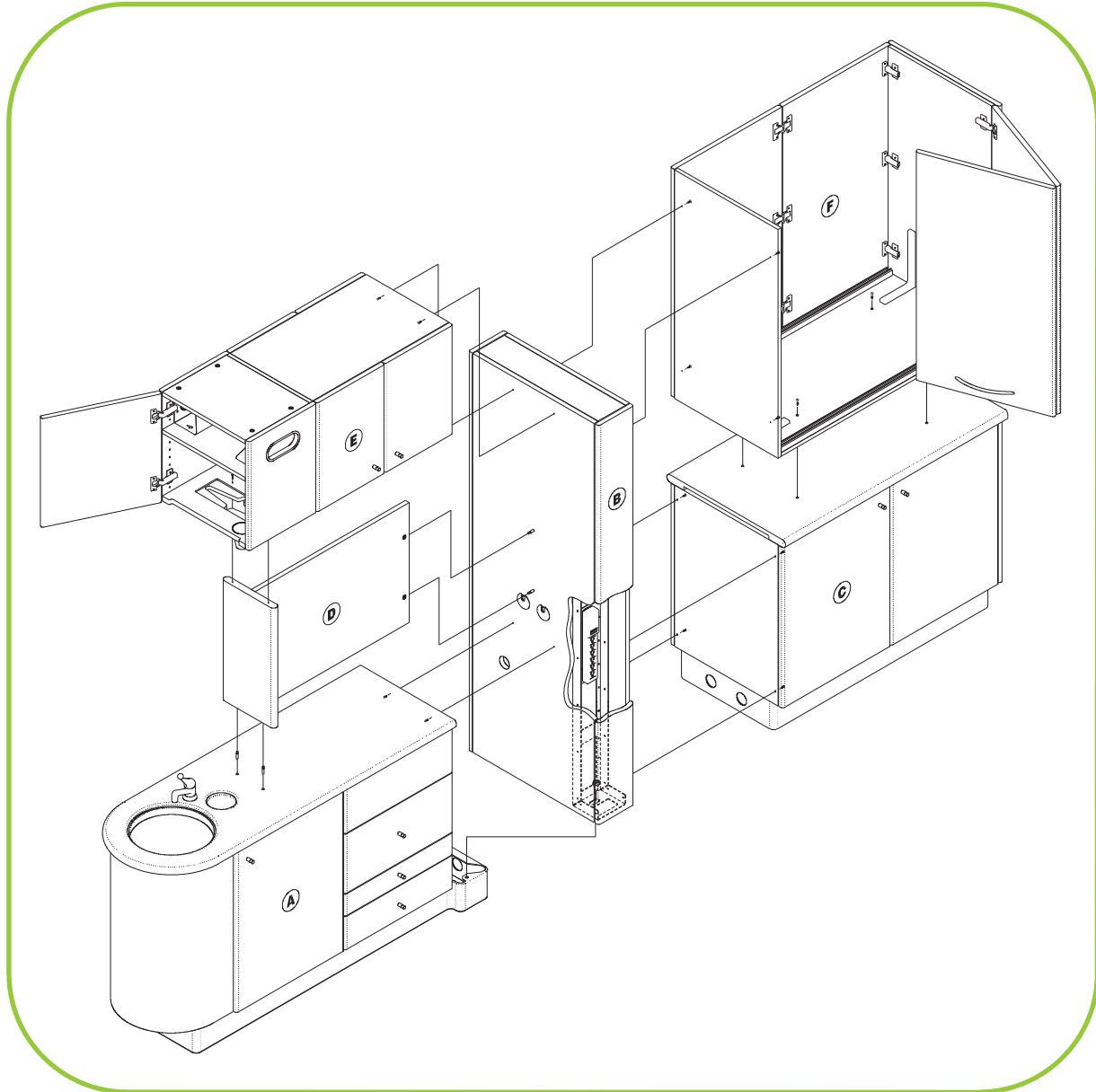

**STEP 1:** Install steel bases to floor as shown on the "Steel Base Installation" instruction page 14.

**STEP 2:** The support column (B) is bolted to the steel base of subassembly (A) and screwed together.

**STEP 3:** Subassembly (C) is fastened to support column (B)

**STEP 4:** Hutch (D) is fastened down to the counter and to support column (B).

**STEP 5:** Upper subassembly (E) is fastened to support column (B).

**STEP 6:** The pass through x-ray cabinet (F) is screwed to support column (B) and subassembly (C).

## ASSEMBLY

RS PEX

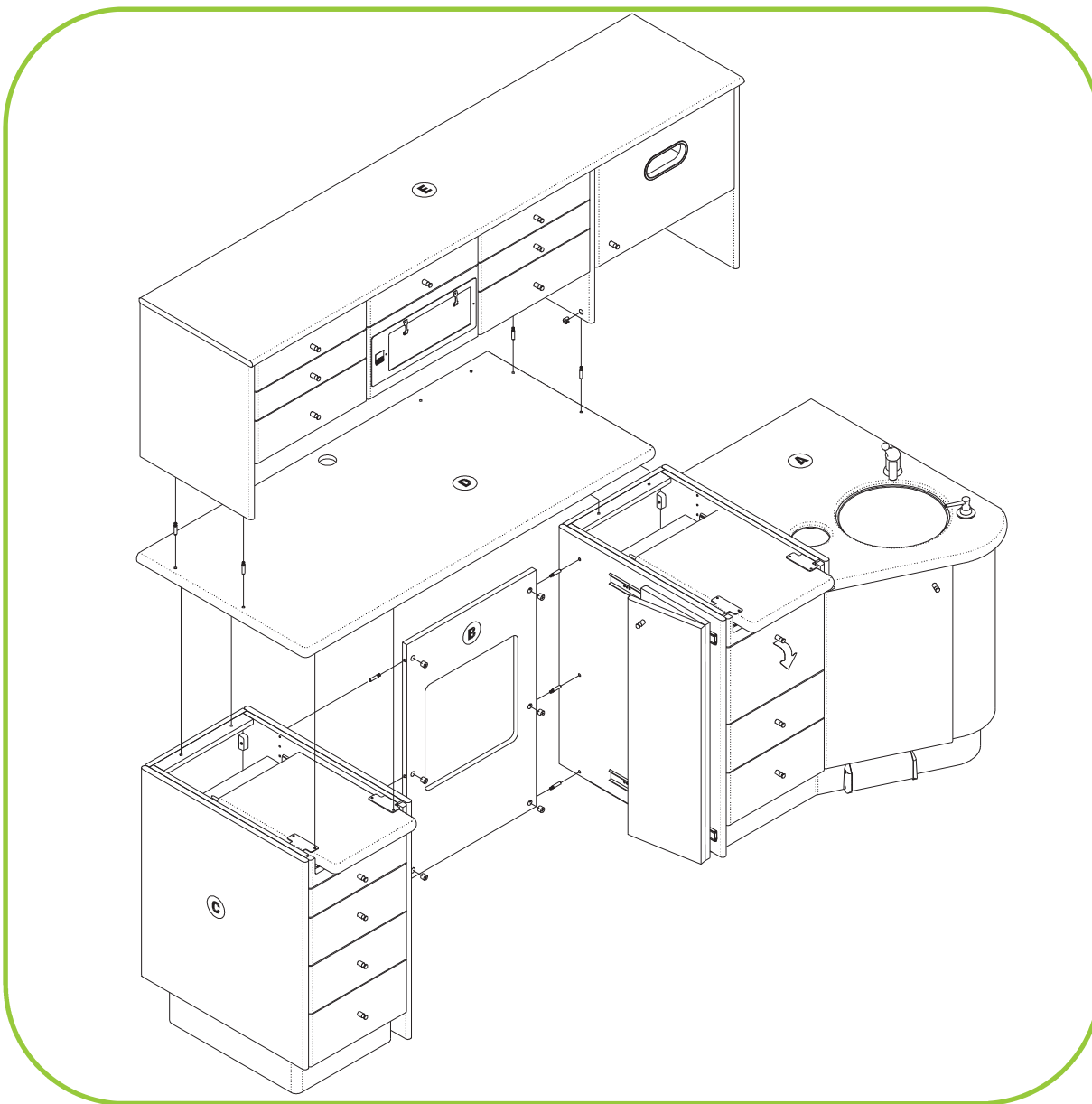

**STEP 1:** Subassembly (A) is set and leveled in the desired location.

**STEP 2:** Rear panel (B) is attached to subassembly (A).

**STEP 3:** Subassembly (C) is set and leveled, then attached to rear panel (B).

**STEP 4:** Counter (D) is set on top and fastened to the assembled base section.

**STEP 5:** Hutch (E) is set on and attached to the counters.

## ASSEMBLY

### STERILIZATION CENTRE ASSEMBLY

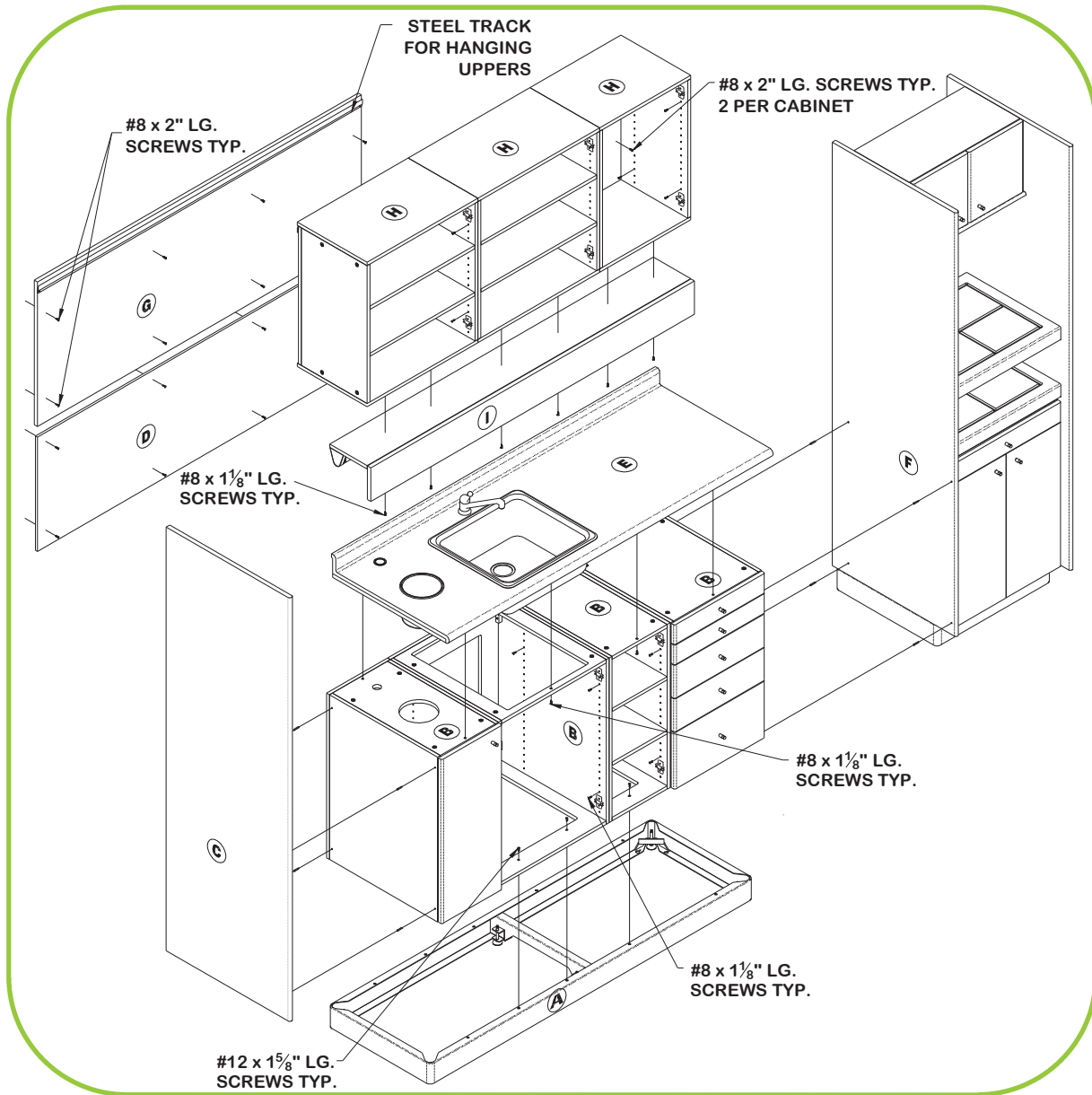

**STEP 1:** Attach all the base cabinets (B) to the steel base (A), and the side panel (C) is attached.

**STEP 2:** Set backsplash (D) on the base cabinets and attach to the wall. Counter (E) goes on base cabinets next.

**STEP 3:** Sterilization tower (F) is screwed to base cabinets and upper cabinet support (G) is set on backsplash and fastened.

**STEP 4:** Upper cabinets (H) are hung on the support panel.

## INSTALLATION

### STEEL BASE

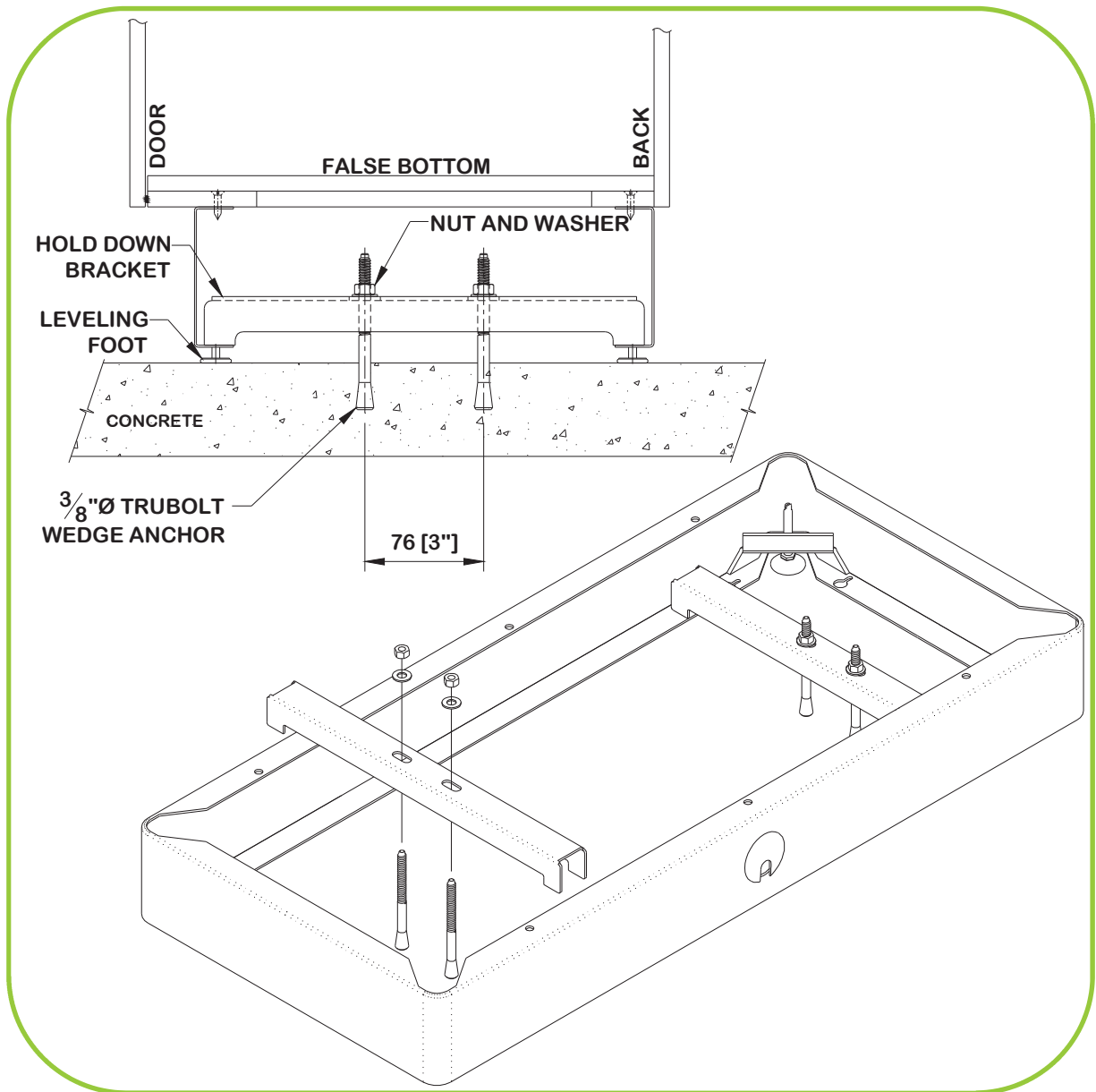

## INSTALLATION

### PASS THROUGH X-RAY CABINET

